



//M E-1	EXTERNAL BATTERY ADAPTOR	
		ME2510
USER MANUAL		
M-SERIES ELECTRIC OUTBOARD MOTORS		

Momentum ME-1 user manual

This manual describes the installation and operation of the Momentum M-Series External Battery Adapter (ME-1) for use with the Momentum M-Series electric outboard motors.

Please read this manual comprehensively as it contains crucial information on set-up, operation, maintenance and safety. By using this Momentum product, it is deemed that you have read and understood the contents of this user guide and Momentum accepts no liability in the event of misuse of this product.

We reserve the right to update this user guide in-line with any evolution of this product.

Please visit our website for the latest version of this user guide.



www.momentumelectricmarine.com

ANATOMY + SPECIFICATIONS

ME-1 ANATOMY

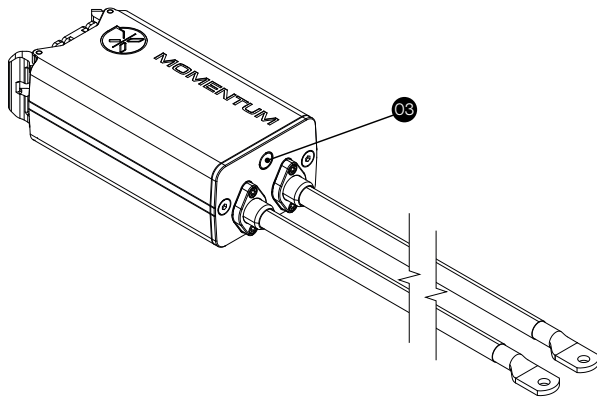
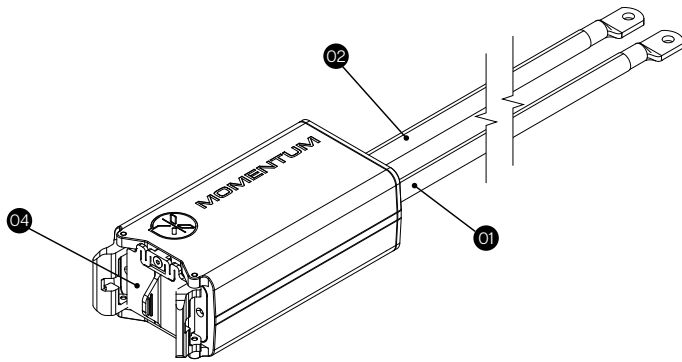

- 01 Positive cable, Red. M6 ring lug.
- 02 Negative cable, Black. M6 ring lug.
- 03 Status indicator LED
- 04 Female socket

ME-1 SPECIFICATIONS

INPUT VOLTAGE RANGE	60V - 84V
OPERATING TEMPERATURE	-20° - 70°C
IP RATING	IP67
DIMENSIONS	L 157 X W 75 X H 52

EXTERNAL BATTERY SPECIFICATIONS

DISCHARGE CURRENT	≤150A
MAXIMUM VOLTAGE	84V
NOMINAL VOLTAGE	72V

DECLARATION OF CONFORMITY

Product: ME-1 External Battery Adaptor
Model: ME-1

The objects of the declaration are in conformity with the following directives and harmonised standards:

- EN IEC 55014-1:2021
- EN IEC 55014-2:2021
- EN IEC 61000-3-2: 2019+A2:2024
- EN IEC 61000-3-3: 2013+A2:2021+AC:2022-01
- EN IEC 62368-1

FCC statement

This device complies with the CFR Title 47 Part 15 Subpart B:2020 of the FCC rules

IMPORTANT SAFETY NOTICE

- **DO NOT CONNECT TO A BATTERY THAT EXCEEDS THE MAXIMUM VOLTAGE (84V).**
- **Check that the cables on the ME-1 are in good condition.**
- **Check that the polarity is correct.**
- **Ensure the battery is switched off before connecting the adaptor or use an anti-spark connector.**
- **Ensure that the connectors are dry before connecting.**

EXTERNAL BATTERY DISCLAIMER

- **If required, change the ring lugs to the connector that matches your battery.**
- **The battery level indicator displayed on the OBM screen is based off the actual voltage of the external battery and may not accurately represent remaining capacity.**
- **There will be no range and time remaining display on the OBM. Please ensure that your battery has its own accurate state of charge indicator.**
- **Momentum is not responsible for the safety or performance of the external battery.**

INSTALLATION & OPERATION

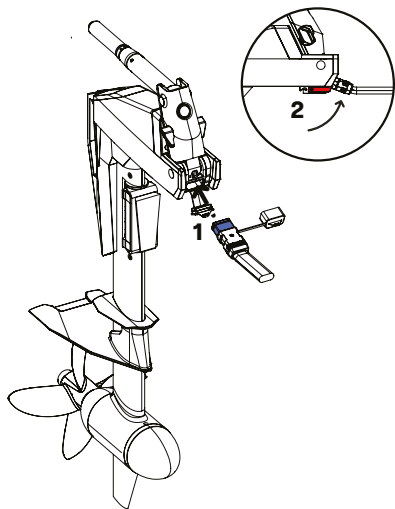

Dia. 1.1

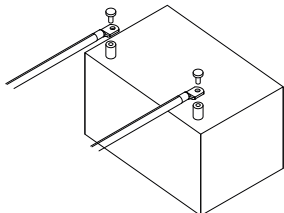

Dia. 1.2

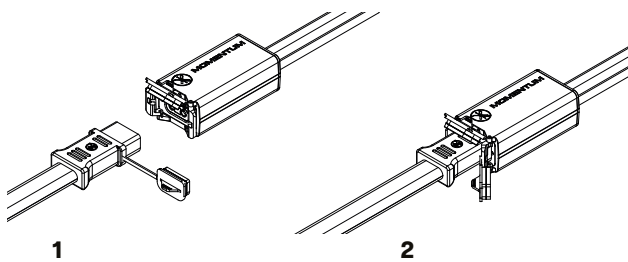

Dia. 1.3

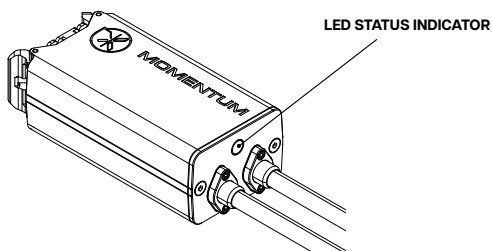

Dia. 1.4

Using the adaptor

- 1.1. Place battery in a covered area of the boat. Do not expose battery to continuous sunlight or immerse in water.
- 1.2. Connect the M-Series power cable to your Momentum M-Series outboard. (Dia. 1.1)
- 1.3. Connect ME-1 to the battery. (Dia. 1.2)
- 1.4. Connect the M-Series power cable to ME-1. (Dia. 1.3)
- 1.5. Turn on the external battery.
- 1.6. The ME-1 status indicator LED will light. Please refer to the LED status indicator chart below for the next course of action. (Dia. 1.4)

LED light	Status	Action
Solid Green	Connected to 3rd party battery and outboard. Detected battery voltage is 64V or higher.	Safe to proceed.
Solid Red	Connected to 3rd party battery, but not connected to the outboard.	Connect to M-Series outboard motor
Blinking Red	Detected battery voltage is less than 64V.	Battery unsuitable, please use a suitable battery.

